

Permitted wear for trailer couplings and drawbar eyes for road traffic

1. Trailer coupling

1.1 Coupling pin

● Diameter

- automatic coupling 40 mm
94/20/EC class S, DIN 74051, ISO 8755,
ROCKINGER couplings for Switzerland
ROCKINGER gauge 57026 (ill. 1)
Wear limit 36,5 mm

In case the gauge slips over the coupling pin:
coupling pin must be replaced

- automatic coupling 50 mm
94/20/EC class C, DIN 74052, ISO 1102
ROCKINGER gauge 57122 (ill. 1)
Wear limit 46,5 mm

In case the gauge slips over the coupling pin:
coupling pin must be replaced

● Vertical play

- 4 mm (ill. 2)
(RO*400, RO*430, RO*460, RO*500, RO*530, RO*560:
2 mm)

1.2 Bearing:

- **NO longitudinal play!** (ill. 3)

● Vertical play:

- 3 mm in axle of coupling pin (ill. 4)

1.3 Lower bush

- 40 mm
Wear limit ϕ 29,2 mm
ROCKINGER couplings RO*225, RO*227
Wear limit ϕ 31,5 mm
ROCKINGER couplings RO*256, RO*260,
RO*39, RO*400, RO*430, RO*433, RO*460
Wear limit ϕ 35,2 mm
ROCKINGER couplings RO*263, RO*42

- 50 mm
Wear limit ϕ 34,2 mm
ROCKINGER couplings RO*700, RO*710, RO*715
ROCKINGER gauge 57277
Wear limit ϕ 35,9 mm
ROCKINGER couplings RO*500, RO*530, RO*560
ROCKINGER gauge 57334



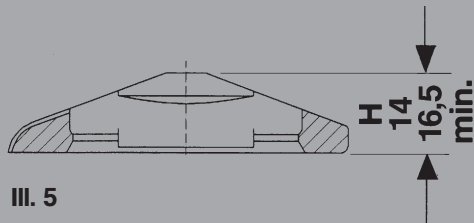

III. 5

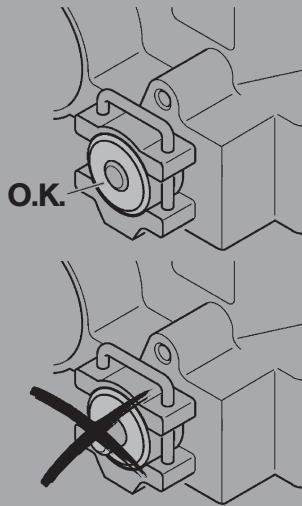

III. 6

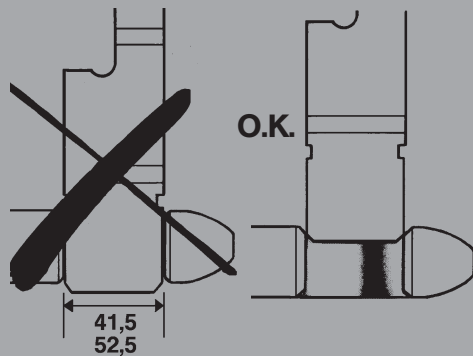

III. 7

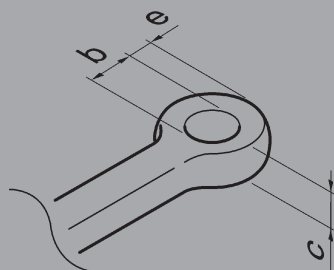

III. 8



1.4 Support ring

- If drawbar eye can touch lower bush because of wear,
- If wear limit **H** (40 mm coupling **14 mm**, 50 mm coupling **16,5 mm**, s. ill. 5) has been reached: **support ring must be replaced.**

Lower bush must not be damaged under any circumstances as this will impair closure of coupling!

1.5 Check at the safety pin (ill. 6)

- engaged, locked and ensured: **O.K.**

- Not ensured: **Risk of accident!**

1.6 Funnel

The funnel must be **locked** for hitching.

2. Drawbar eye

- **40 mm:**
94/20/EC class S, **DIN 74054, ISO 8755**, drawbar eye for Switzerland
ROCKINGER gauge **57026** (ill. 7)
Wear limit 41,5 mm
- **50 mm:**
94/20/EC class D, **DIN 74053, ISO 1102**
ROCKINGER gauge **57122** (ill. 7)
Wear limit 52,5 mm

- the bore of the drawbar eye must not be worn-out.
- in case the gauge slips into the bore: **drawbar eye must be bushed or replaced**

ill. 8

DIN / CH	b ¹ max. (mm)	c min. (mm)	e ² min. (mm)
74054	41,5	28	22
74053	52,5	41,5	23,5
drawbar eye CH	41,5	36,5	29,5

¹ Dimension with bush

² Dimension without bush

Member of JOST-World